

Rameswara
waterview

Rameswara Group Enterprises

GB, Rameswara Apartment
19A, Sarat Bose Road, Kolkata 700020
Tel: 91 33 30576921/22, Fax: 91 33 30576924
Website: www.rameswara.com

Marketed by



Ph: +91 9830467788
(033) 40162222
E-mail: marketing@modernproperties.in



Ph: +91 9051806000
+9330090222
E-mail: waterview@4walls.co.in

Disclaimer: The contents describe the conceptual plan only and are subject to changes at the sole discretion of the architect/developer.

A TRISYS PRODUCT info@trisyscom.com

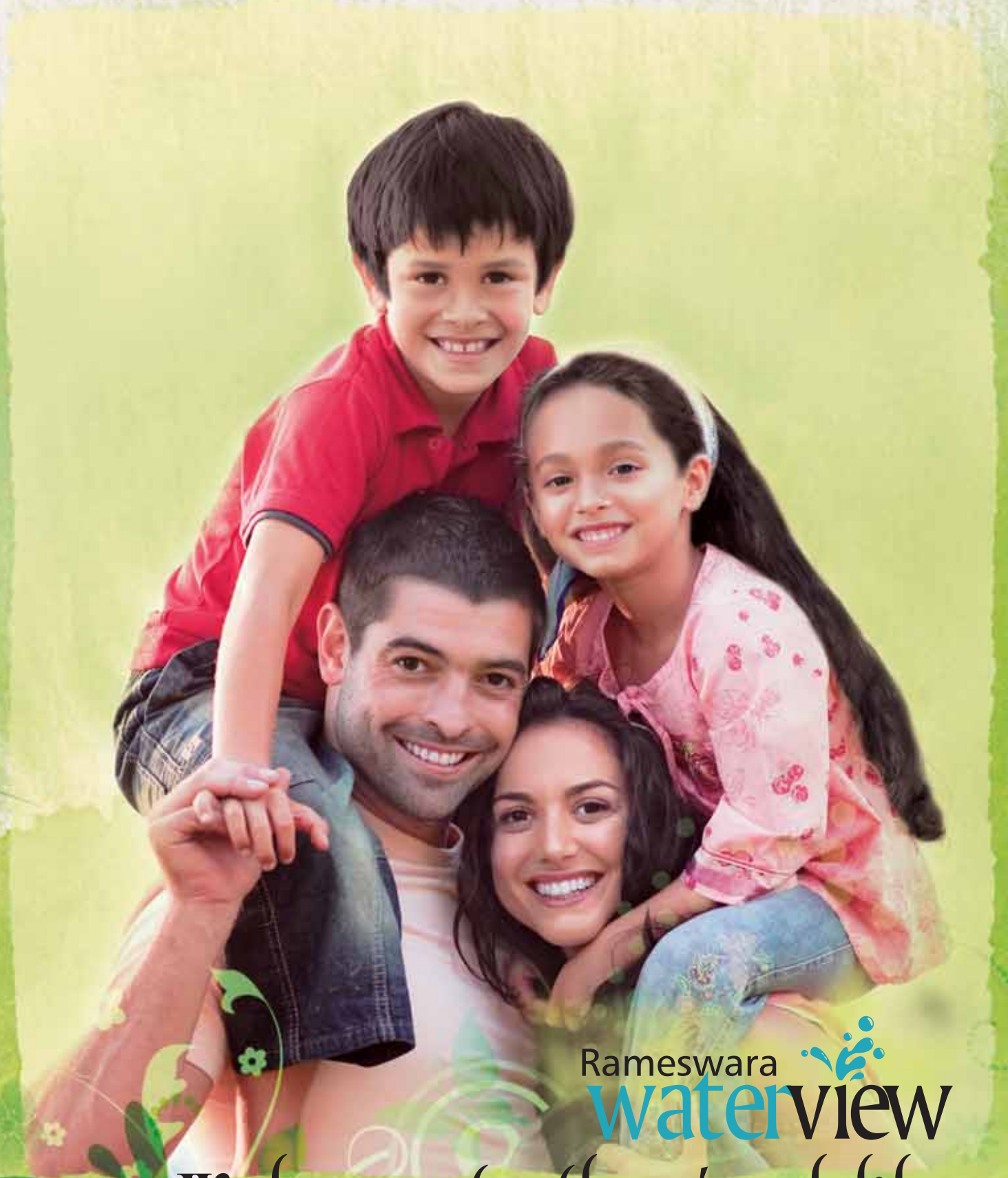

Rameswara
waterview

Welcome to the good life.



Privacy. Peace. Quiet.
Luxury. Convenience.
Openness.

Welcome to the
good life.

At Rameswara
Waterview.

Live your life under the calm
spell of water. Prosper in a
4.5-acre green environment that
fills you with peace at night,
refreshes you each morning and
engages you into vivacity with its
shimmering sunlight.

Enjoy long walks along tree-lined
boundries and take in the
serenity of a 1.5-acre lake.



The logo for Rameswara WaterView features the name in a sans-serif font. 'Rameswara' is in a dark grey color, and 'WaterView' is in a teal color. To the right of the text is a stylized icon of a water splash or fountain in the same teal color.

Rameswara
WaterView

- 4.5-acre total area (270 cottahs)
- 1.5-acre lake
- 15 blocks
- 2 and 3 BHK apartments



Clubhouse



An all-residents' club at Rameswara Waterview will offer something for everyone. From infant to the elderly, all community members will find their entertainment and social needs fulfilled to the hilt.



State-of-the-art facilities include:

- Swimming pool
- Mini pool for children
- Indoor games room – pool table, T.T. table, carrom and other board games
- Badminton court
- Air conditioned community hall
- Air conditioned guest rooms
- Indoor gymnasium
- Children's play area
- Landscaped garden



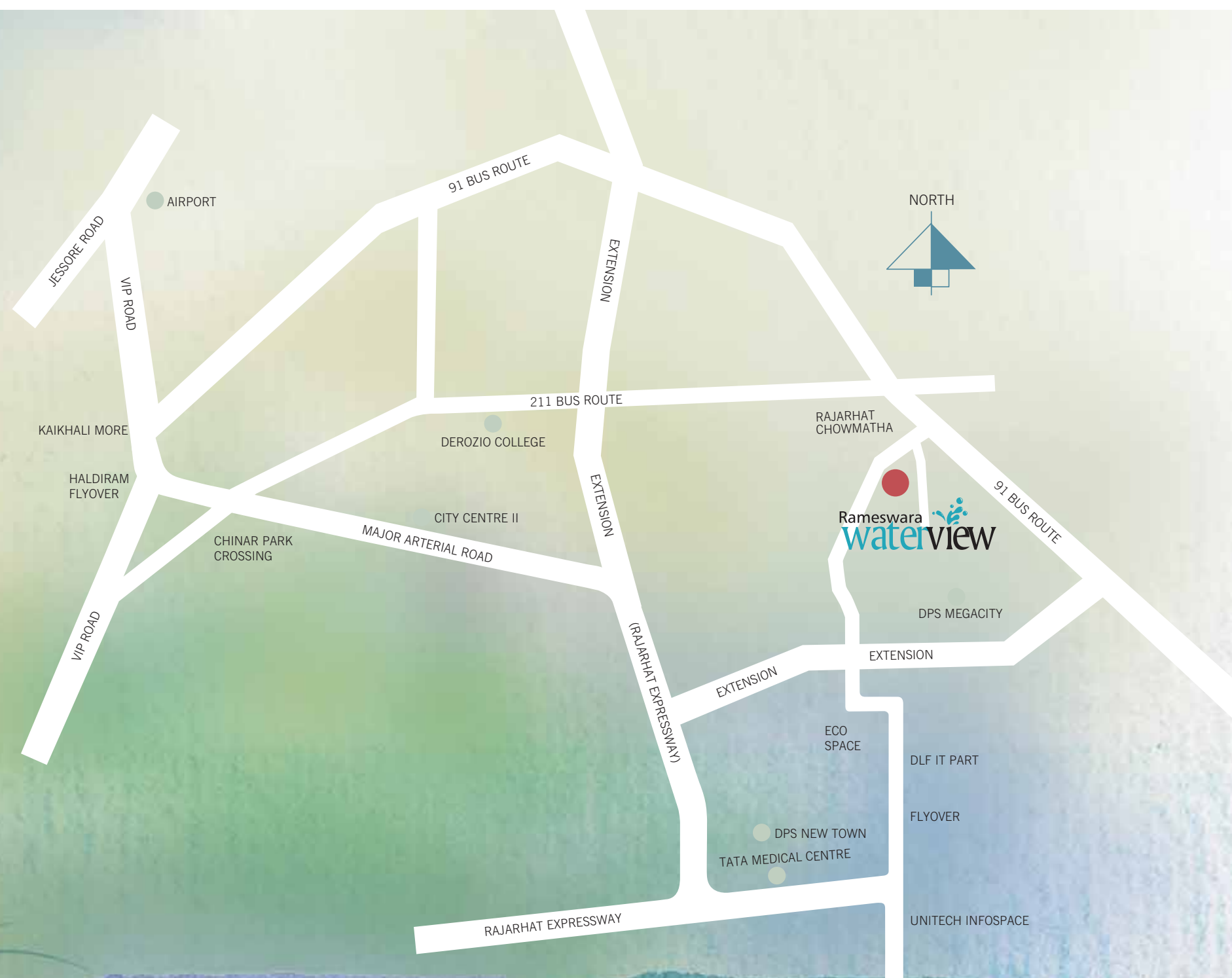

A neighbourhood is only as good as its surrounding pin code. And its surrounding peace. At Rameswara Waterview, distances are only a matter of minutes. So that you're never too far from the world.

- Proximate to:**
- Markets
 - Schools
 - Hospitals
 - The airport
 - City Centre New Town

Promoters' profile

The Rameswara Group is one of the foremost in the Kolkata real estate sector and is associated for the last four decades with a number of projects that adorn Kolkata's skyline – Rameswara Apartments, Metro Towers, Metro Plaza, The Residency, Tolly Gardens, Sunflower Gardens, the British Deputy High Commission and South City Projects (partners), to name a few. The Rameswara Group emulates a number of aspects looked for by prospective buyers while investing in real estate:

- Property appreciation: All properties of the Rameswara Group have appreciated significantly in value over time. Thus, you can always be sure of a lucrative long-term investment when buying into Rameswara.
- Timely delivery: Rameswara projects have always been synonymous with on-time delivery.
- Maintenance: All Rameswara building complexes are well maintained due to maintenance-friendly designs and products used.
- Clean legal working: At Rameswara, we are transparent and law abiding. You can be assured a hassle-free stay in terms of legal paper work.
- Preferred housing: We look for a particular mix in our buyers, so that the housing communities we develop may be occupationally diverse and multi-racial, facilitating healthy community functioning.





Master plan

Rameswara **waterview** OFFERS:

- Club
- Children play area
- Water body with open-air seating
- Landscaped garden



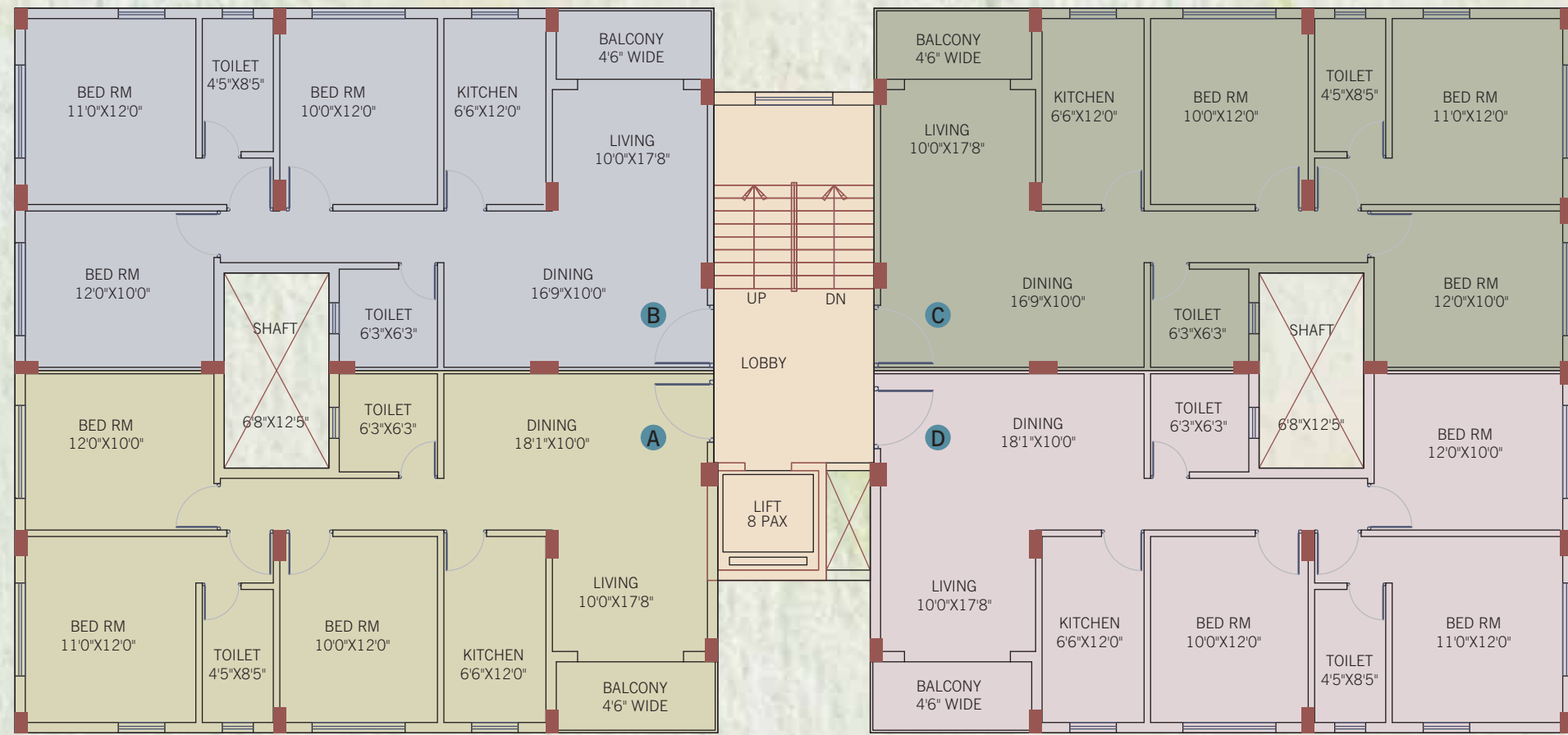

Typical floor plan
(Block 1, 2, 5)

Flat	Chargeable area (sft)	BHK
A	1230	3
B	1225	3
C	1225	3
D	1230	3

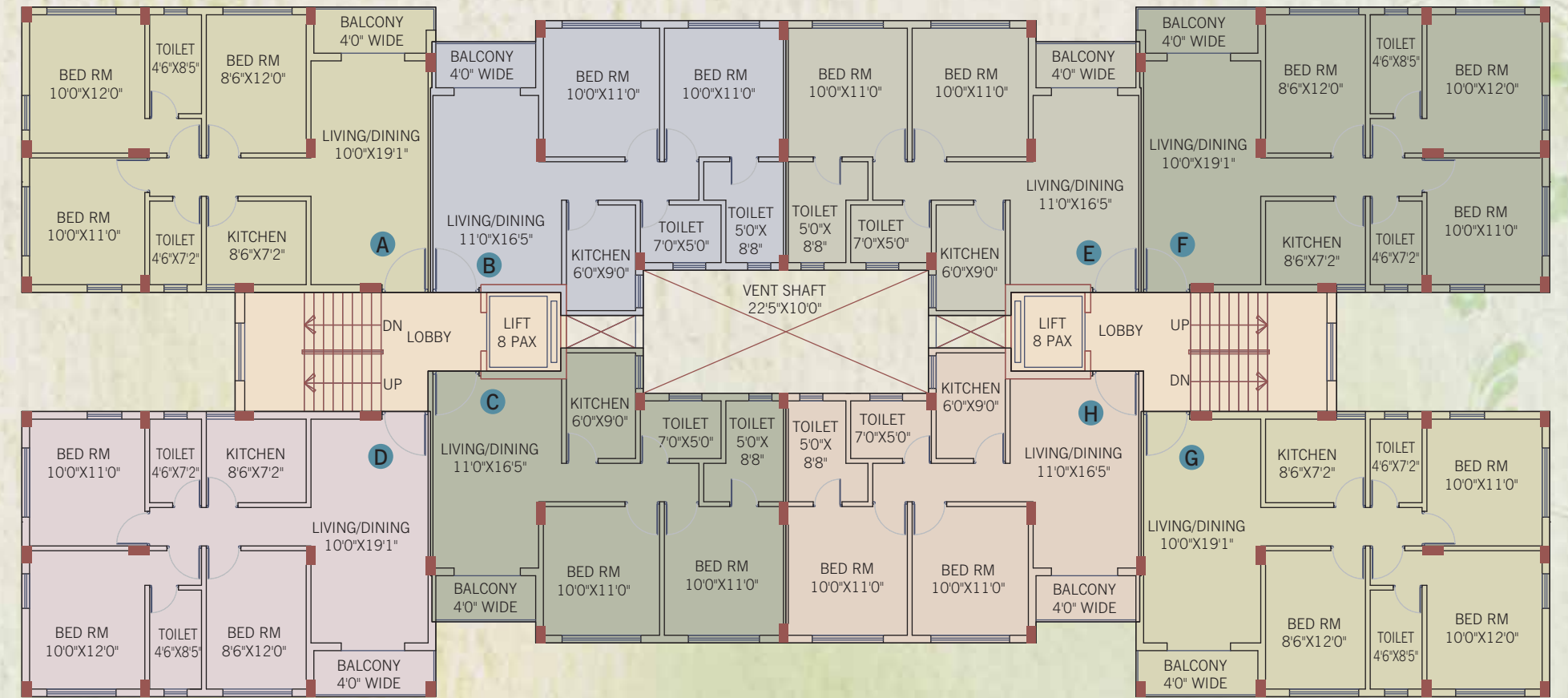

Typical floor plan
(Block 3, 4, 8, 10)

Flat	Chargeable area (sft)	BHK
A	1065	3
B	850	2
C	850	2
D	1070	3
E	850	2
F	1065	3
G	1070	3
H	850	2

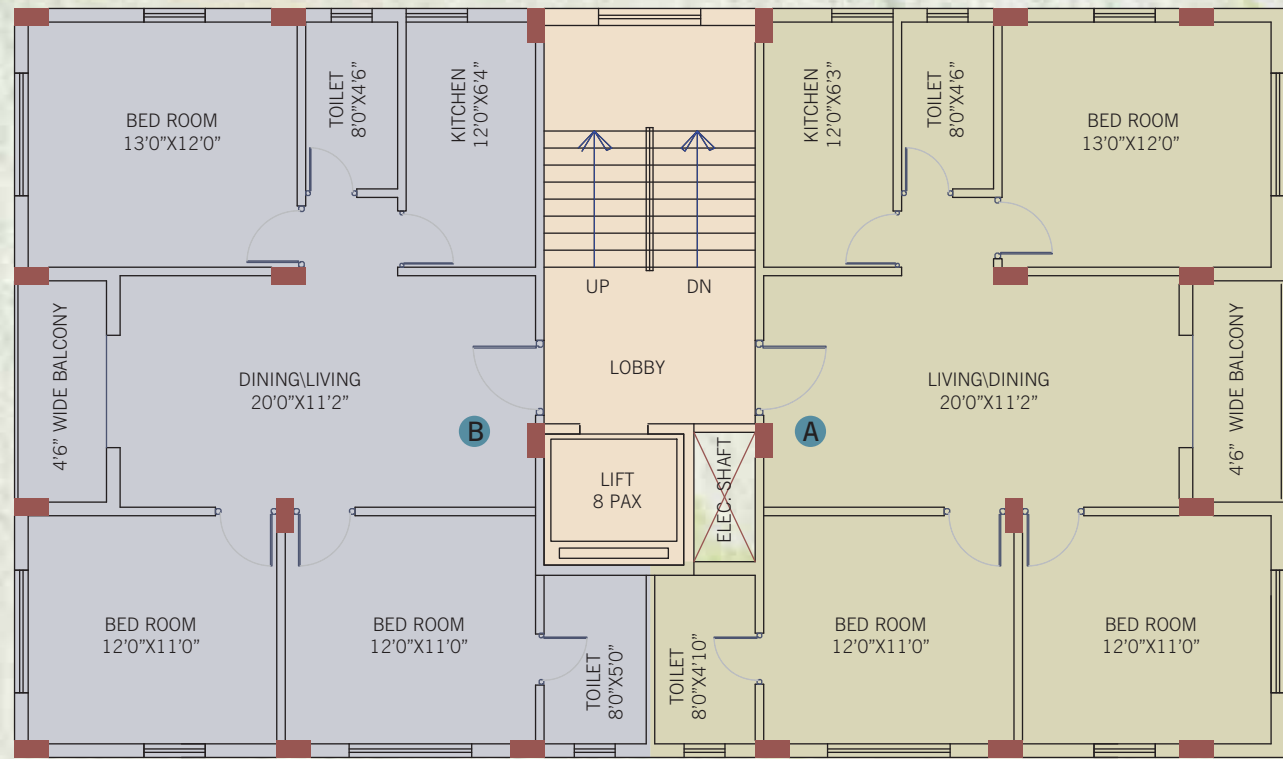

Typical floor plan
(Block 6)

Flat	Chargeable area (sft)	BHK
A	1215	3
B	1215	3



Typical floor plan
(Block 7)

Flat	Chargeable area (sft)	BHK
A	1315	3
B	1315	3



Typical floor plan
(Block 9, 11, 12)

Flat	Chargeable area (sft)	BHK
A	1055	3
B	905	2
C	1050	3
D	1050	3
E	905	2
F	1055	3

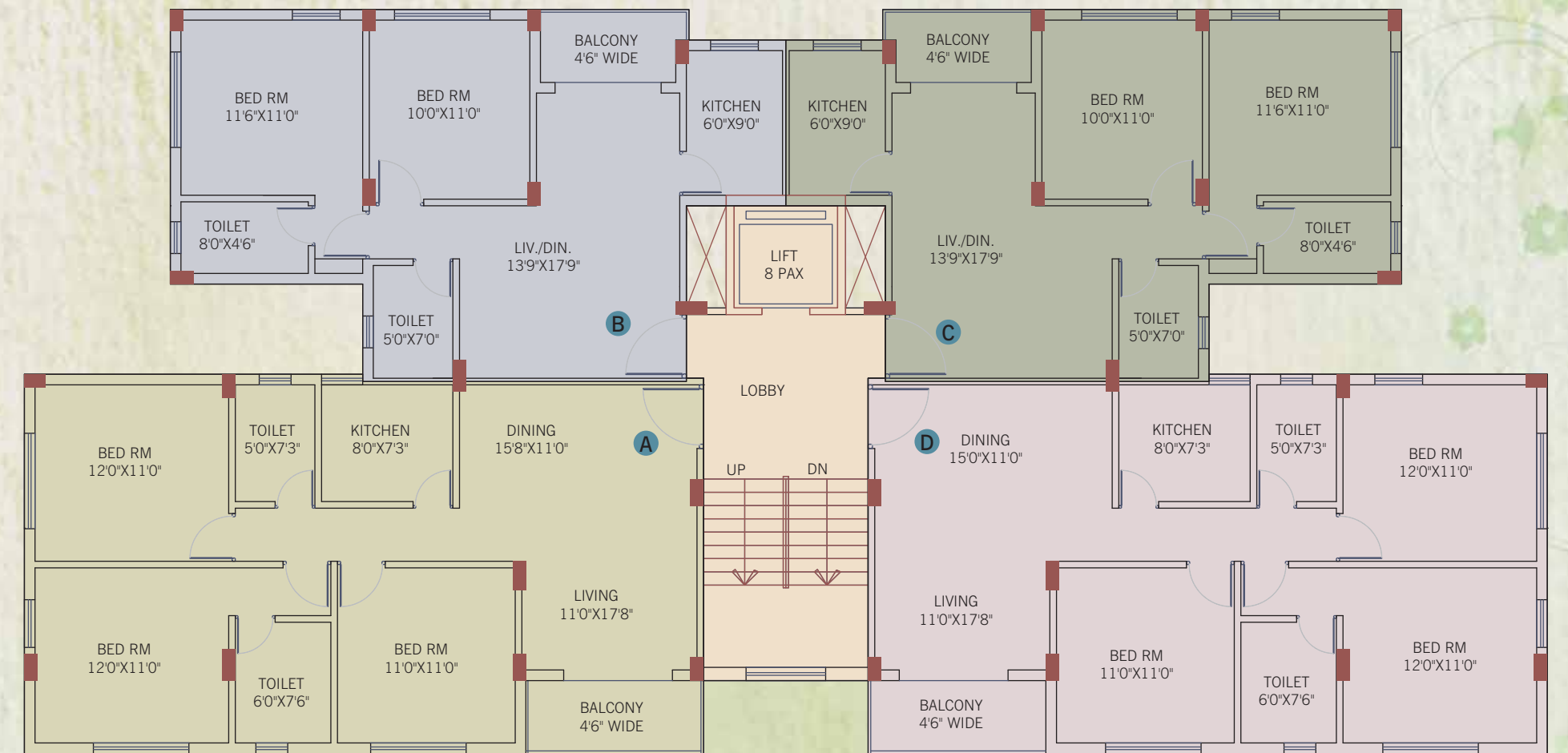

Typical floor plan
(Block 13, 14, 15)

Flat	Chargeable area (sft)	BHK
A	1220	3
B	910	2
C	910	2
D	1220	3



Specifications

Foundation

- RCC structure

Wall finish

- Internal - Plaster of Paris
- Toilet - Dado of ceramic tiles up to door height
- Kitchen - Dado of ceramic tiles 2 ft above platform

Flooring

- Living room and bedrooms - Vitrified tiles
- Toilets - Ceramic tiles
- Common areas - Vitrified tiles

Doors

- Flush door with accessories

Windows

- Aluminium windows

Kitchen

- Granite platform with stainless steel sink

Plumbing

- Concealed pipeline using standard materials

Sanitaryware

- CP fittings of a reputed make
- White porcelain fittings

Electricals

- AC point in bedrooms and living room
- Concealed copper wiring
- Modular switches
- Telephone and T.V. points in bedrooms and living room

Connectivity

- Intercom facility

Waste and water management

- 24-hour water supply
- Water treatment plant
- Sewage treatment plant

Power backup

- Free for common area
- 0.5 KVA for each flat*

Fire fighting system

- State-of-the-art fire fighting system

Security

- Electronic surveillance system in common areas

Elevators

- Eight passenger elevators

Common toilets at ground level

Adequate parking facilities

Provisional store

* At extra cost

Developed by



www.rameswara.com

Architect



MEP Consultant



Enkon Engineering Consultants Pvt Ltd.

Solicitors & Advocates

R.L. Gaggar